

**Dijital Baskı Altı Hazırlama  
( Padding )**

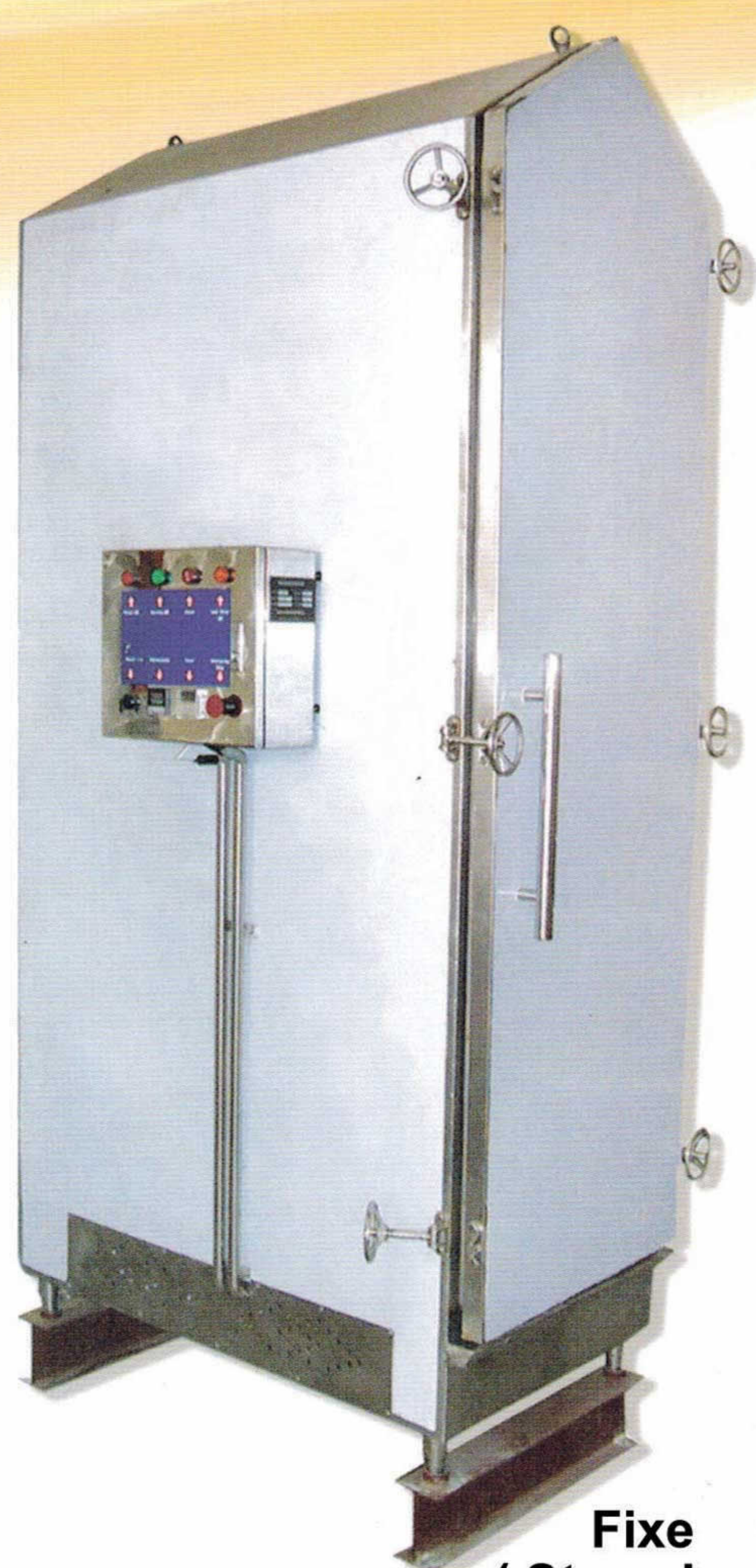

**Fixe  
( Steaming )**

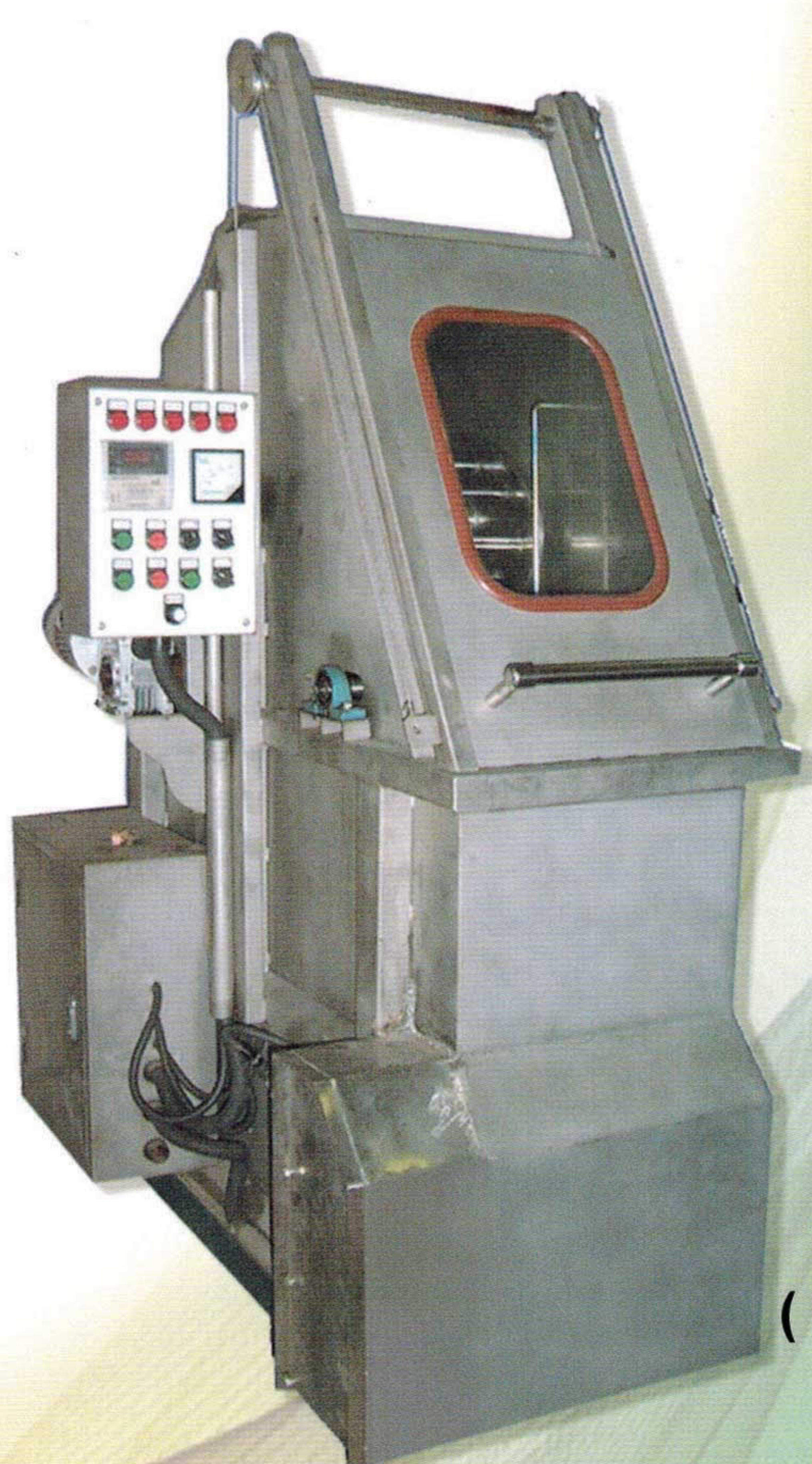

**Yıkama  
( Washing )**

# Pre & Post Process Machine

\*Illustration, descriptions, and technical data are not binding and may be change without prior notice.

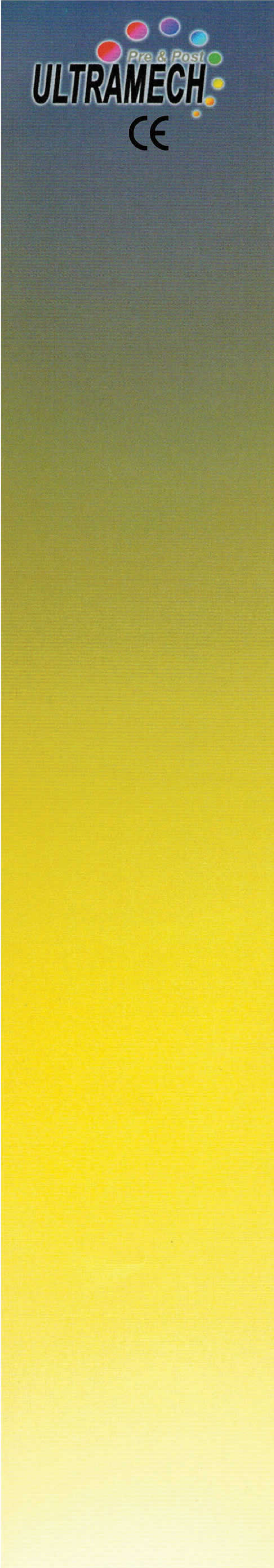

## Specifications

Padding & Dryer Machine	
Max Fabric Width	1600mm
Fabric Transport	Automatic edge sensor system
Dryer	Infra red light bulbs with minimum three levels of heat control
Fabric Receiver	Separate control unit to allow work with padding machine or work as a stand alone unit
Dimension	450cm x 240cm x 130cm
Voltage	415V / 50-60Hz
Power Rating	9-20 KVA
Current	35 Amp

Steamer Machine	
Capacity	30m length of fabric / 1.6m width
LED Indicator	Power, Heating, Alarm & Lack of water
Thermometer	102°C
Method	Heating / Steam
Structure	Stainless Steel
Dimension	140cm x 120cm x 270cm
Voltage	415V / 50-60Hz
Electrical Consumption	12 KVA / 35 AMP

Wince Machine	
Capacity	50m length of fabric
Panel	Main Switch, Power, Forward & Reverse
Method	Hot & Cold wash
Structure	Stainless Steel
Dimension	131cm x 99cm x 302cm
Voltage	415V / 50-60Hz
Electrical Consumption	25 KVA / 63 AMP

## Operational Environments

## Total Process - Product Finish

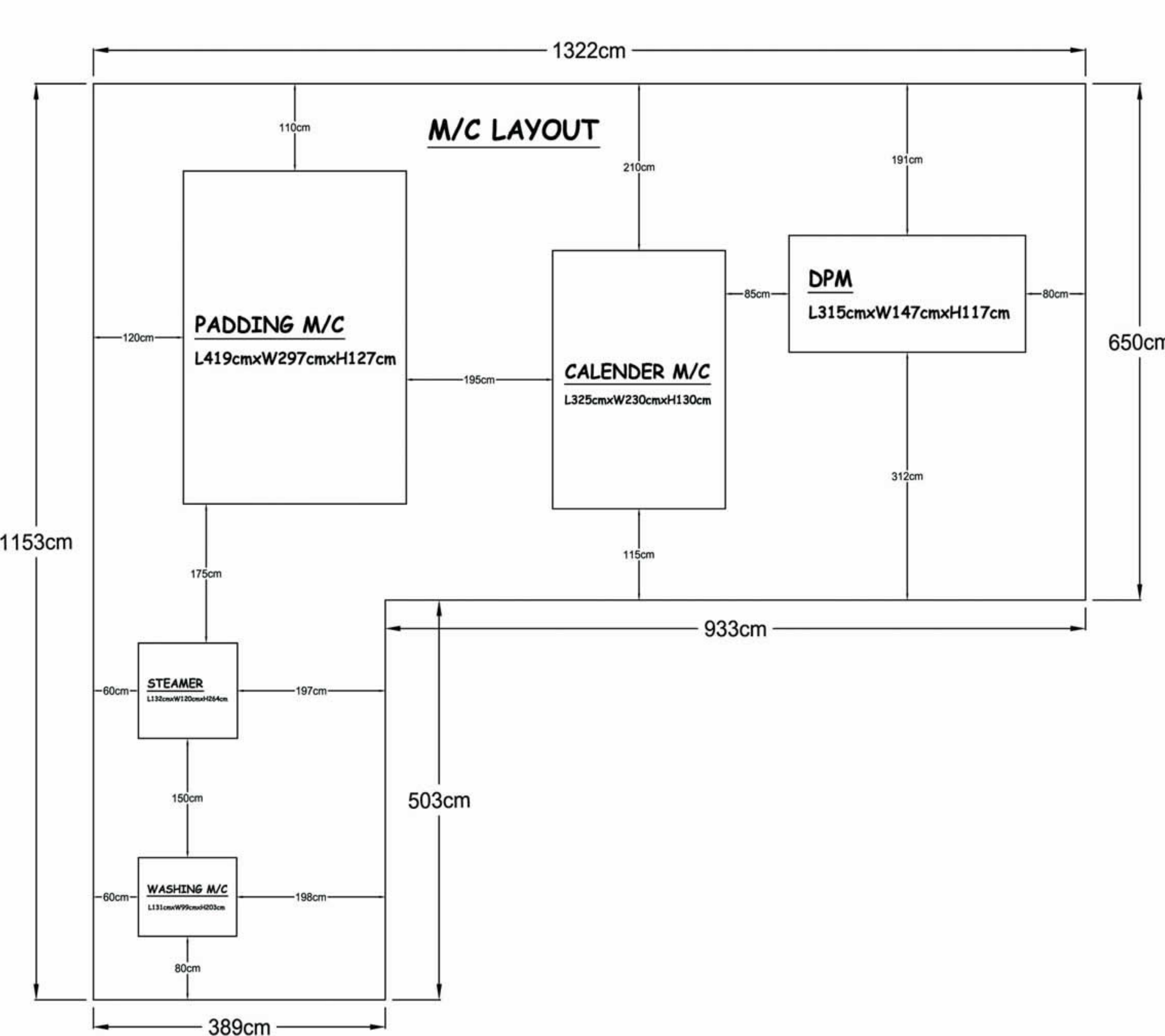

This layout shows the space requirements for a printing unit with necessary pre and post process Equipments - approx . around 100 sq.mtr.built up area. In addition to this working area of around 50 sq.mtr is also required for stock maintenance.

Shown below is the complete process required for Digital Print Finishing :

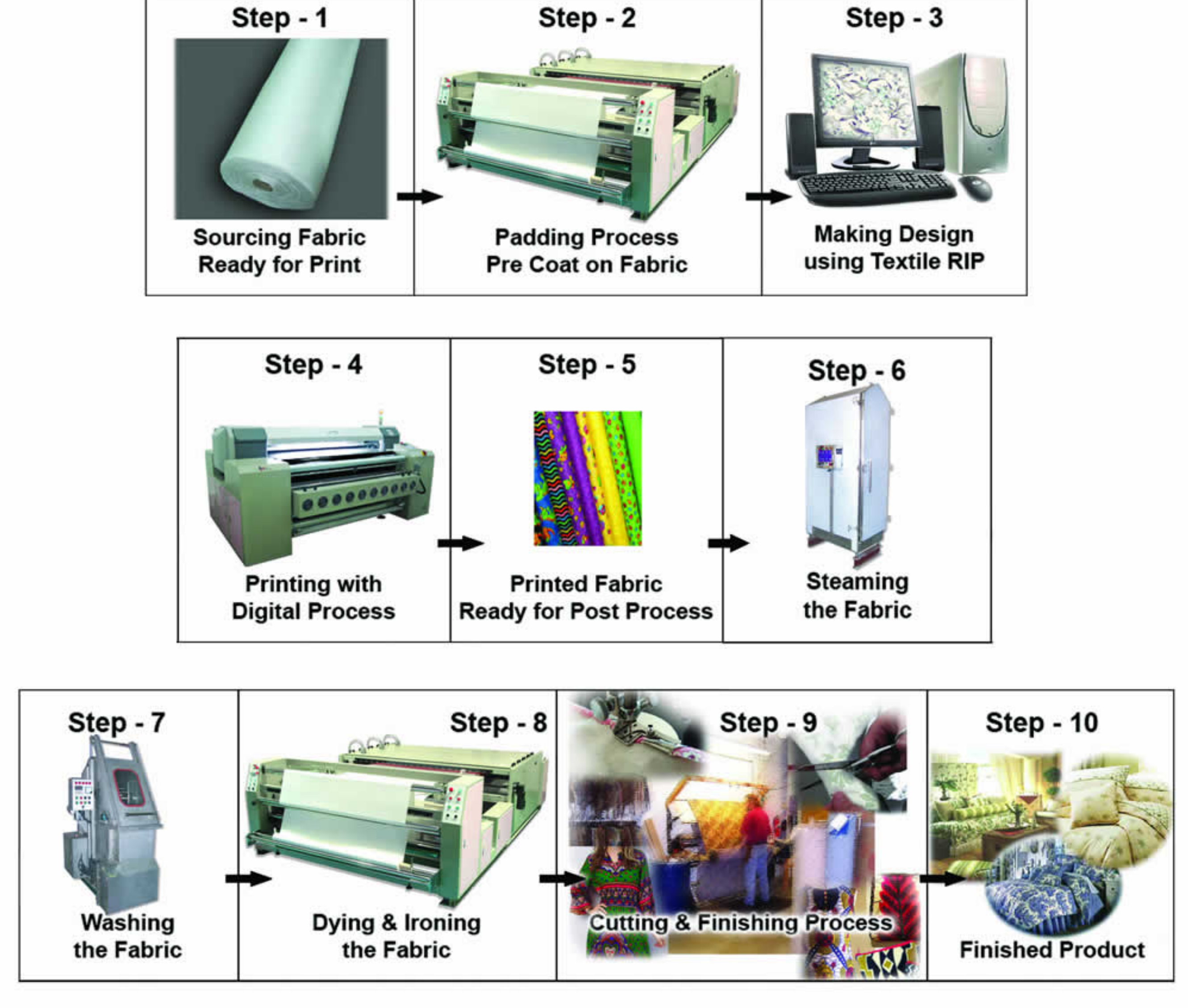

The above process are all mandatory in convention printing also. Pre Printing process will be more in conventional printing such as Designing, Color Separation, Screen Making, Squeezing, Washing Etc. Where as in digital RIP & PRINT is the simplified concept.

Distributor :  
KOTONLAYN TEKS. VE KONF. TIC. SAN. LTD. STI.  
YALOVA YOLU 4. KM. BUTİM İŞ MERKEZİ  
C / 5 NO: 1486 - 87 BURSA / TÜRKİYE  
TEL : +90 224 211 33 35 (Pbx)  
FAX : +90 224 211 33 32  
E-MAIL : cottonlinetex@hotmail.com